

# HOBO® MicroRX Station for HOBOnet® (RX2105 and RX2106) Quick Start

## 1 Log into HOBOLink.

Go to [www.hobolink.com](http://www.hobolink.com) and log into an existing account or create a new one. You'll receive an email to activate the account.

## 2 Register the station.

In HOBOLink, click Devices, then RX Devices. Click the Register a Device link. Give the station a name and enter the serial number and device key from the label inside the station door.

**Note:** If you are using your own micro SIM card, follow the instructions at [www.onsetcomp.com/support/manuals/23845-installing-micro-sim-rx2100-station](http://www.onsetcomp.com/support/manuals/23845-installing-micro-sim-rx2100-station) before continuing.

## 3 Plug in smart sensors if applicable.

Plug in smart sensors into the ports below the LCD and route the cables through the holes in the cable channel.

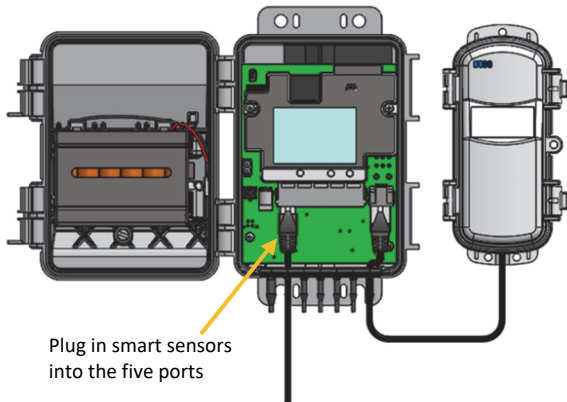

## 4 Plug in the battery and wait for the station to connect to HOBOLink.

- a. Plug in the battery cable. For RX2106 models, plug in the solar panel cable for the built-in solar panel.

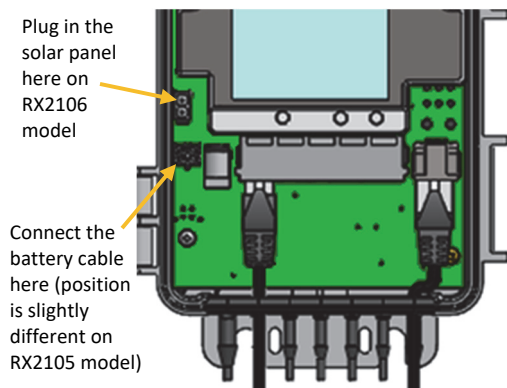

Once the battery cable is plugged in, "Initializing System" will flash on the LCD. A checkmark appears next to "System" after the station initialization is complete.

- b. After the station powers up, it will connect to HOBOLink automatically within two minutes. The cellular icon and "Connection" will flash while the connection is underway. Once the connection is complete, a checkmark appears next to Last Connection. Note that the entire initialization process

may take several minutes; wait until Last Connection and the checkmark appears before continuing to step 5.

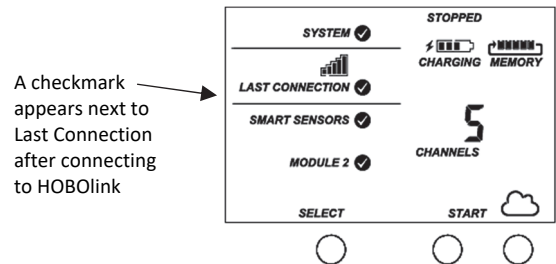

A checkmark appears next to Last Connection after connecting to HOBOLink

## 5 Add any wireless sensor motes.

**Important:** Keep the mote(s) near the station while completing these steps.

- a. Press select to switch to the module 2 and then press the Search button to wait for motes to join the network. The magnifying glass icon will blink while the station is in search mode waiting for motes to join the network.

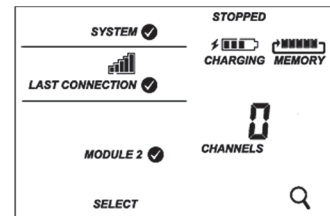

Press the Select button to switch to module 2

Press the Search button for the station to search for motes to join

- b. Install the batteries in the mote and press the button on the mote for 3 seconds.

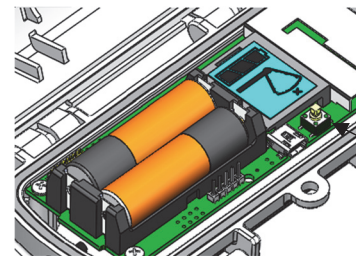

- c. Watch the mote LCD during the process of joining the network.



This signal strength icon blinks while searching for a network.



Once a network is found, the icon will stop flashing and the bars will cycle from left to right.



This network connection "x" icon blinks while the mote completes the registration process, which may take up to five minutes.



Once the mote has finished joining the network, the "x" icon is removed and the channel count on the station LCD increases by the number of measurement channels for the mote plus the battery.

- 
- d. Repeat these steps to add other notes. Press the Search button on the station when finished adding notes.
- 

## 6 Configure the station in HOBOLink.

In HOBOLink, click Devices, then RX Devices, and click the  icon next to your station. Make changes and click Save on each screen as you configure the following:

- General system settings (nickname, time zone, and image)
  - Readout settings (connection interval and night mode)
  - Smart sensor logging and sampling interval and settings for each smart sensor (e.g. labels, graph, and scaling)
  - Wireless sensor logging and settings for each wireless sensor (e.g. labels, graph, and scaling)
- 

## 7 Start Logging.

Press the Start button on the station to start logging. The station will connect to HOBOLink and then logging will begin.

Measurements are uploaded to HOBOLink each time the device connects. Go to [www.hobolink.com](http://www.hobolink.com) and click Help for details on checking the latest conditions, setting up dashboards, exporting data, and more.



**For additional information:** See the product manual for specifications and detailed operation, including deployment and mounting guidelines. Go to [www.onsetcomp.com/support/manuals/24500-rx2105-and-rx2106-manual](http://www.onsetcomp.com/support/manuals/24500-rx2105-and-rx2106-manual) or scan the code at left.