

**S**PLIT CORE current transformers make installation easier because they can be installed without disconnecting the circuit being measured. Split-core current transformers are available in a range of stock sizes and rated currents to meet your measurement

Model		Model		Model	
CTS-0750-(xxx)		CTS-1250-(xxx)		CTS-2000-(xxx)	
0.75" I.D.		1.25" I.D.		2.00" I.D.	
Rated Amps	Model Suffix (xxx)	Rated Amps	Model Suffix (xxx)	Rated Amps	Model Suffix (xxx)
5	-005	70	-070	400	-400
15	-015	100	-100	600	-600
30	-030	150	-150	800	-800
50	-050	200	-200	1000	-1000
70	-070	250	-250	1200	-1200
100	-100	300	-300	1500	-1500
150	-150	400	-400		
200	-200	600	-600		

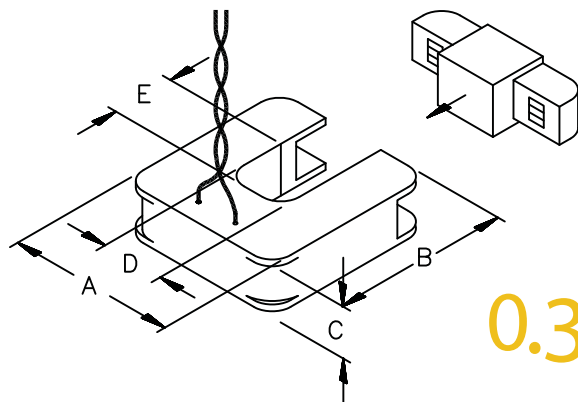

0.333 VAC Output

Size	CTS-0750	CTS-1250	CTS-2000
A	2.00 in. 5.08 cm	3.25 in. 8.25 cm	4.75 in. 12.1 cm
B	2.10 in. 5.33 cm	3.35 in. 8.51 cm	5.00 in. 12.7 cm
C	0.61 in. 1.55 cm	1.00 in. 2.54 cm	1.20 in. 3.05 cm
D	0.75 in. 1.91 cm	1.25 in. 3.18 cm	2.00 in. 5.08 cm
E	0.75 in. 1.91 cm	1.25 in. 3.18 cm	2.00 in. 5.08 cm



**OneTemp<sup>®</sup>** Pty Ltd  
MEASURE | CONTROL | RECORD  
[www.onetemp.com.au](http://www.onetemp.com.au)  
1300 768 887

## SPLIT CORE CURRENT TRANSFORMERS



Split Core  
Easy Installation

- No exposed metal parts on assembled transformer.
- Internal precision burden resistor across secondary.
- Epoxy encapsulated housing.
- Leads-8ft. twisted pair, 22 AWG.
- Core interleaved at joints for accuracy.
- Phase angle is measured at 50% of rated current.
- UL & CE recognized for voltages up to 600VAC.
- 0.333 VAC output at rated current.
- Accuracy  $\pm 1\%$  from 10% to 130% of rated current..
- Phase angle < 2 degrees for CTS-0750 models >70Amps & CTS-1250 models >150Amps.
- Snap closing/opening feature.
- RoHS Compliant